

**CITY OF WHITE SALMON
ORDINANCE NO. 2019-05-1042**

AN ORDINANCE ANNEXING CERTAIN REAL PROPERTY TO THE CITY OF WHITE SALMON AND THEREBY INCORPORATING SAID PROPERTY WITHIN THE CORPORATE LIMITS OF THE CITY OF WHITE SALMON

WHEREAS, on July 6, 2018 the City of White Salmon received an initial Notice of Intent to Annex approximately 2.10 acres in size, located adjacent to Spring Street and adjacent to city limits on the east side of the subject area, to City of White Salmon known as the Klebba/Baxter Annexation WS-ANX-2018-002; and

WHEREAS, on August 20, 2018 the City of White Salmon received an initial Notice of Intent to Annex approximately 10.34 acres in size located adjacent to Spring Street and NW Main Avenue and adjacent on the south, west and north by the City of White Salmon known as the White Annexation WS-ANX-2018-003; and

WHEREAS, on September 19, 2018 the City Council conducted a meeting with the initiating parties as required by RCW 35A.114.120 and accepted and combined the notices of intent to annex, identified the annexation area, specified that the adopted pre-annexation zoning of R1 Single-Family Residential, would apply to the property upon annexation and that the property proposed to be annexed would be subject to any outstanding indebtedness; and

WHEREAS, a complete and sufficient annexation petition was submitted to the City of White Salmon on February 26, 2019. The petition was transmitted to Klickitat County Assessor on February 26, 2019 to determine its sufficiency. On April 18, 2019, the city received a response from the Klickitat County Assessor indicating the petition contained valid signatures representing 64.84% of the total assessed valuation of the property proposed to be annexed; and

WHEREAS, on May 15, 2019, the City Council held a public hearing on the annexation proposal pursuant to RCW 35A.14.130 following notice published in the newspaper of record (The Enterprise) on May 1 and May 8, 2019 and,

WHEREAS, the City Council finds that the proposed annexation is consistent with the Comprehensive Plan and will allow for future orderly growth;

NOW, THEREFORE, the City Council of the City of White Salmon do ordain as follows:

Section 1. The property, as set forth below in the Legal Description and for which the petition for annexation is filed, shall be and is hereby made a part of the City of White Salmon and annexed thereto.

Legal Description

The proposed annexed area is located within the Columbia River Gorge Scenic Area White-Salmon Urban Exempt Area and includes Klickitat County Parcels 03111909100200, 03102475000400, 03111969000600, 03111969000500, 03111969000700, 03111970000300, 03102475000100, 03102475000300, 03111970000100, 03111970000200, 03111922000700, 0310247500200 . The annexation area is bounded on the west by current city limits of White

Salmon; is bounded on the east by N. Main Avenue; is bounded on the south by city limits of White Salmon and NW Spring Street and is bounded on the north by city limits of White Salmon (Klickitat County Parcel 03102411001200) and Klickitat County Parcels 031102417000400, 03102411000100, 03111922000200.

Section 2. Pursuant to the terms of the annexation petition, all property within this territory to be annexed hereby shall be assessed and taxed at the same rate and on the same basis as the property within the City of White Salmon, including assessments or taxes in payment of any bond issued or debts contracted by order existing at the time of annexation.

Section 3. In accordance with RCW 35A.14.330, the annexation area shall be subject to the zoning classifications established by the City of White Salmon Municipal Code Section 17 Zoning and shall be zoned R1 Single-Family Residential.

Section 4. The City Clerk is hereby directed to file with the Board of County Commissioners of Klickitat County a certified copy of this ordinance. The City Clerk is further directed to file with the Office of Financial Management a certificate as required by RCW 35A. 14.700 within thirty (30) day so the effective date of annexation.

Section 5. This Ordinance shall become effective 30 days from date of adoption.

Passed by the council and approved by the Mayor on this 15th day of May 2019.

David Poucher, Mayor

ATTEST:

Jan Brending, Clerk/Treasurer

Approved as to form:

Kenneth B. Woodrich, City Attorney

City of White Salmon Annexation WS-ANX-2019-001

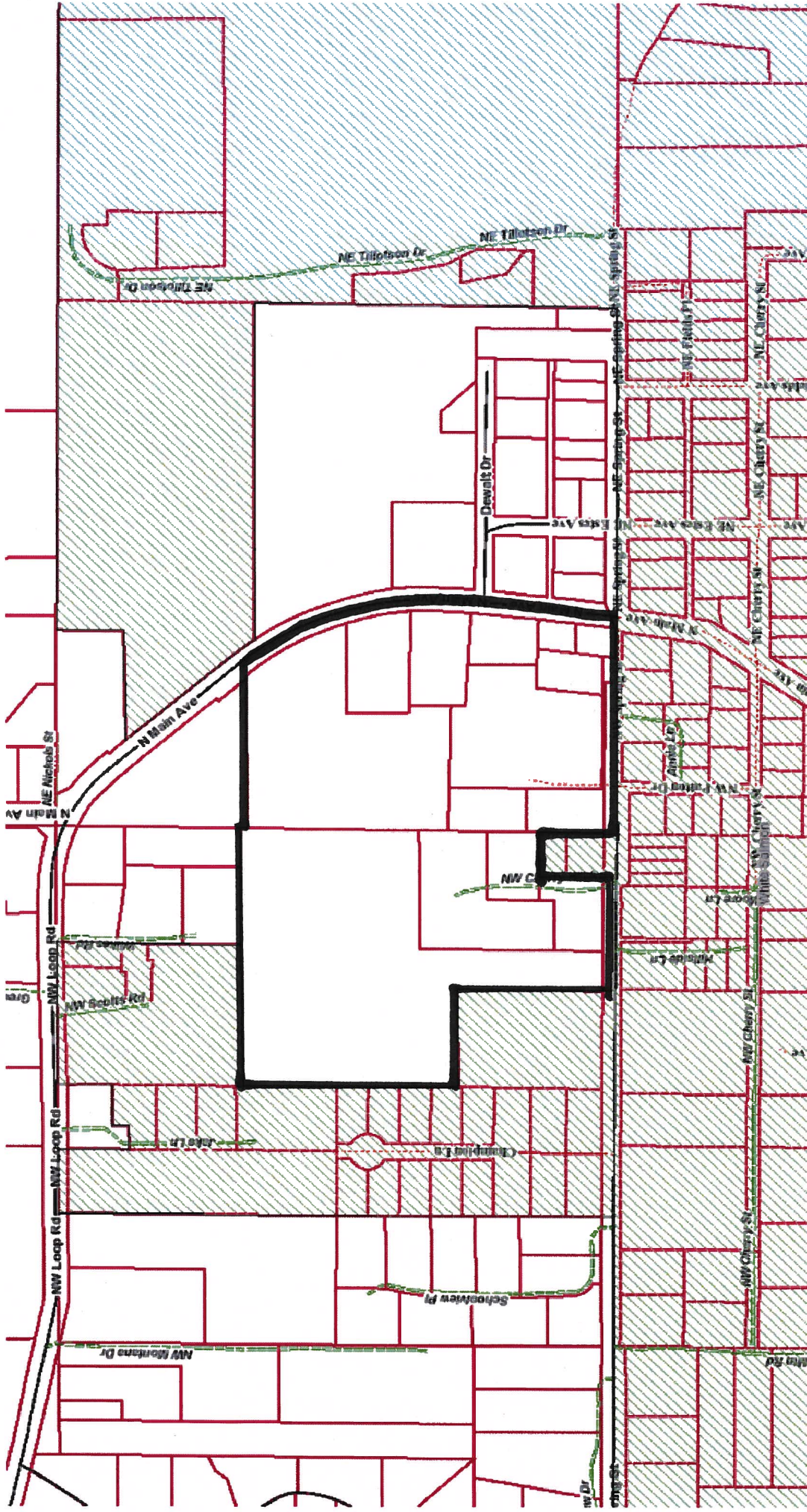

Legend

- County Boundary
- Roads
- Parcels
- Towns (Points)
- City Limits
- City
- County
- Other Govt
- Private
- State



200 ft

Created by Kiklatat County. Kiklatat County provides no warranty, expressed or implied, as to the accuracy, reliability or completeness of this data.