

ORDINANCE NO. 1348

AN ORDINANCE OF THE CITY OF KALAMA, WASHINGTON, RELATED TO THE MODIFICATION OF BOUNDARIES OF OAK STREET BETWEEN THE WEST CITY LIMIT LINE OF KALAMA, CROSSING THE INTERSTATE 5 SOUTHBOUND OFF RAMP AND INTERSTATE 5 NORTHBOUND ON RAMP TO REMOVE COWLITZ COUNTY'S JURISDICTION IN THAT AFFECTED ROADWAY, PURSUANT TO RCW 35A.21.210

WHEREAS, the boundary line between the City of Kalama and Cowlitz County in the area of the Oak Street-Interstate 5 overcrossing lies outside of the existing corporate limits, between Oak Street, Frontage Rd N, Interstate 5 SB Off-Ramp and Interstate 5 NB On-Ramp; and

WHEREAS, Cowlitz County's jurisdiction over segments of Oak Street, Frontage Rd N, Interstate 5 SB Off-Ramp and Interstate 5 NB On-Ramp has created complications relating to the City of Kalama's emergency response and road maintenance operations; and

WHEREAS, pursuant to RCM 36A.21.210, the City of Kalama and Cowlitz County have agreed to revise the corporate boundary of the City of Kalama so as to fully include that segment of Oak Street, Frontage Rd N, Interstate 5 SB Off-Ramp and Interstate 5 NB On-Ramp as described herein such that it will be located within the boundaries of the City of Kalama; and

WHEREAS, such revision of the corporate boundary between City of Kalama and Cowlitz County would be of benefit both to the City of Kalama and its citizens and to Cowlitz County and its citizens; and

WHEREAS, the Kalama City Council held a public meeting taking action to accept jurisdiction over the affected roadway and forward to the Cowlitz County for their approval;

NOW THEREFORE, the City Council of the City of Kalama do ordain:

Section 1. The corporate boundary line between the City of Kalama and Cowlitz County is hereby revised to fully include in the corporate limits of the City of Kalama that segment Oak Street lying between Oak Street, Frontage Rd N, Interstate 5 SB Off-Ramp and Interstate 5 NB On-Ramp as described below and as depicted in Exhibit "B" attached hereto and incorporated herein by reference:

A parcel of land lying in the northeast one-quarter of Section 7, Township 6 North, Range 1 West, Willamette Meridian, Cowlitz County, Washington, more particularly described as follows:

BEGINNING at an angle point in the City Limits Boundary of Kalama, Washington per City of Kalama Ordinance 455, being the intersection of the east/west centerline of said Section 7, with the easterly right of way line of the Burlington Northern Santa Fe Railroad right of way; Thence, northwesterly, along said City Limits, being said easterly Railroad right of way line, to an angle point in said Ordinance 455; Thence, northeasterly, leaving said City Limits Line, perpendicular to said Railroad right of way line, to a point on the City Limits Boundary of Kalama, Washington, per City of Kalama Ordinance 1204

(Auditor's File Number 3355238), being the easterly right of way line of Primary State Highway No. 1 (SR-5); Thence, southeasterly, along said City Limits Boundary, to a point on said City Limits Boundary per Ordinance 455, being said centerline of Section 7; Thence, westerly, along said City Limits Boundary to said POINT OF BEGINNING.

Section 2. Any act consistent with the authority and prior to the effective date of this ordinance is hereby ratified and affirmed.

Section 3. Severability. If any section, subsection, paragraph, sentence, clause, or phrase of this ordinance is declared unconstitutional or invalid for any reason, such decision shall not affect the validity of the remaining parts of this ordinance.

Section 4. This Ordinance shall take effect five (5) days following its passage and publication in the official newspaper of the CITY OF KALAMA, and the Clerk is hereby directed to cause the same to be so published.

PASSED by the City Council and APPROVED by the Mayor at a regular meeting of the City Council held on the 19th day of November, 2014.

Mayor Pete Poulsen

Attest:

Coni McMaster, Clerk/Treasurer

Approved as to form:

City Attorney

Published: 11-22-14

Effective: 11-27-14

Exhibit "A"

Annexation to the City of Kalama, WA Oak Street and I-5

July 17, 2014

Page 1 OF 1

A parcel of land lying in the northeast one-quarter of Section 7, Township 6 North, Range 1 West, Willamette Meridian, Cowlitz County, Washington, more particularly described as follows:

BEGINNING at an angle point in the City Limits Boundary of Kalama, Washington, per City of Kalama Ordinance 455, being the intersection of the east/west centerline of said Section 7, with the easterly right of way line of the Burlington Northern Santa Fe Railroad right of way; Thence, northwesterly, along said City Limits, being said easterly Railroad right of way line, to an angle point in said Ordinance 455; Thence, northeasterly, leaving said City Limits line, perpendicular to said Railroad right of way line, to a point on the City Limits Boundary of Kalama, Washington, per City of Kalama Ordinance 1204 (Auditor's File Number 3355238), being the easterly right of way line of Primary State Highway No. 1 (SR-5); Thence, southeasterly, along said City Limits Boundary, to a point on said City Limits Boundary per Ordinance 455, being said centerline of Section 7; Thence, westerly, along said City Limits Boundary to said **POINT OF BEGINNING**.

See the attached Exhibit "B", entitled "ANNEXATION TO THE CITY OF KALAMA, WA OAK STREET AND I-5".



EXHIBIT "B" **ANNEXATION TO THE CITY OF KALAMA, WA** **OAK STREET AND I-5**

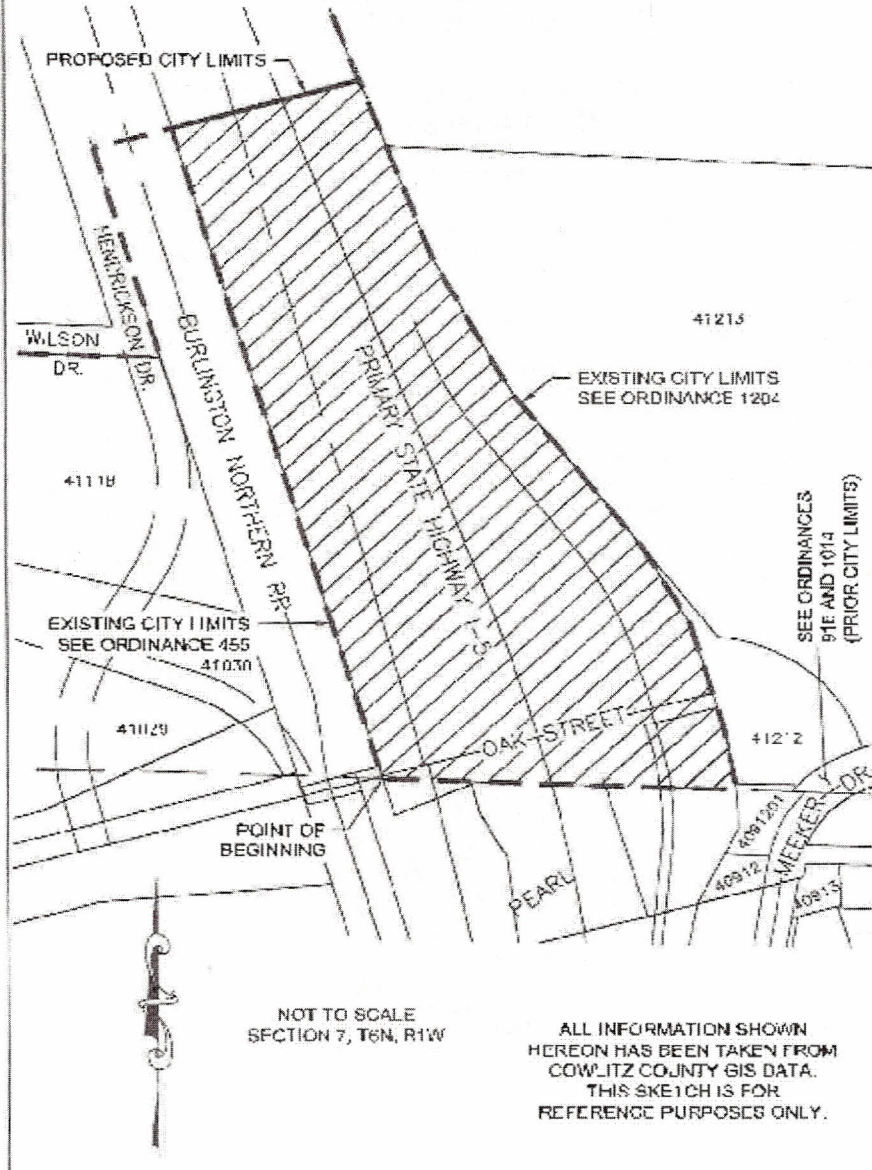

ALL INFORMATION SHOWN
 HEREON HAS BEEN TAKEN FROM
 COWLITZ COUNTY GIS DATA.
 THIS SKETCH IS FOR
 REFERENCE PURPOSES ONLY.

PROJECT ID: CITY OF KALAMA PARCEL NUMBER:
 NAME OF OWNER:
 OWNER ADDRESS:

TAX LOT(S):

PARCEL ADDRESS:

PAGE 1 OF 1

KALAMA ANNEXATION-OAK AND I-5 DWA
 DWG2