

**ORDINANCE NO. 1616-04**

**AN ORDINANCE ANNEXING TO THE CITY OF  
MILTON, WASHINGTON, THE MILTON  
INTERURBAN TRAIL LOCATED IN KING COUNTY,  
COMMONLY REFERRED TO AS THE  
INTERURBAN/HYLEBOS TRAIL ANNEXATION.**

WHEREAS, the City Council of Milton wishes to annex that portion of the Interurban Trail now owned by the City and located within King County; and

WHEREAS, RCW 35A.14.300 allows that legislative bodies of code cities may by a majority vote annex territory outside the limits of such city whether contiguous or noncontiguous for any municipal purpose when such territory is owned by the city; and

WHEREAS, it is in the best interest of the citizens of the City of Milton and of King County that the interurban trail be protected, preserved, and maintained as a trail and open space for the public by the City of Milton; and

WHEREAS, RCW 36.93.090 provides that change in the boundary of a city arising from the annexation of contiguous city owned property held for a public purpose shall be exempt from the requirement of a review by the boundary review board; and

WHEREAS, the City of Milton has complied with all statutory requirements, including those set forth in chapter 35A.14 RCW inclusive and chapter 36.93 RCW inclusive; now, therefore,

THE CITY COUNCIL OF THE CITY OF MILTON, WASHINGTON, DOES  
ORDAIN AS FOLLOWS:

Section 1: The following described property located in King County known as the Interurban Trail and now owned by the City of Milton is hereby annexed to the City of Milton, Washington:

Legal Description: Ptn. Sections 32, 33 and 34, Township 21 North, Range 4 East, W.M.  
Assessor's Tax Parcel ID#s: 187400-1560; 187400-1630; 187400-1695; 187400-1765;  
332104-9093; 332104-9016; 332104-9034; 332104-9088; 342104-9028.

**33-21-4 Curtis Add. To East Tacoma TL's 1560; 1630; 1695; 1765 Certified Copy  
of Decree of Appropriation (Vol. 290 Pg. 168- AF # 217917)  
Seattle Tacoma Interurban Railway vs. The Lake Park Land Railway  
and Improvement Company (A. Randolph & Jane Doe Randolph)**

Lots twelve (12) thirteen (13) fourteen (14) and fifteen (15) in block 21; Lots eleven (11) twelve (12) thirteen (13) fourteen (14) and fifteen (15) in block 22; Lots nine (9) ten (10) eleven (11) twelve (12) thirteen (13) and fourteen (14) in block 23; Lots eight (8) nine (9)

ten (10) eleven (11) and twelve (12) in block 24 of Curtis Addition to East Tacoma, Washington, in the southwest quarter (SW  $\frac{1}{4}$ ) of the southeast quarter (SE  $\frac{1}{4}$ ) of section 33, township 21 north, range 4 east of Willamette Meridian, being all in King County, State of Washington.

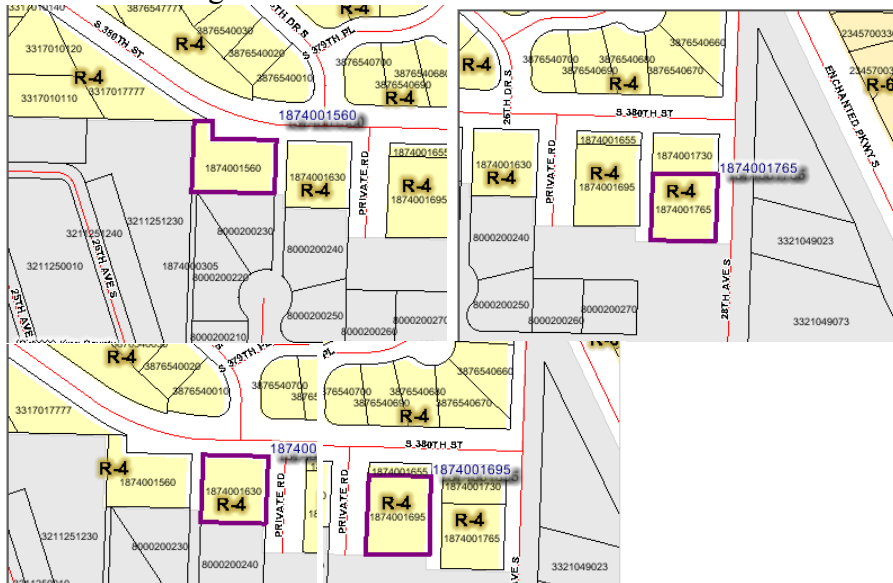

**33-21-4 TL's 93 & 16 Certified Copy of Decree of Appropriation (Vol. 289 Pg. 140-AF # 217924)**

**Seattle Tacoma Interurban Railway vs. A. M. F. McCollough and Emma A. McCollough (Helen Lawrence and John Doe Lawrence)**

A strip, piece, or parcel of land one hundred (100) feet wide, beginning fifty (50) feet in width on each side of the center line of the definite location of the Seattle Tacoma Interurban Railway across the Northwest quarter (NW  $\frac{1}{4}$ ) of the Southwest quarter (SW  $\frac{1}{4}$ ) of Section 33, township 21, north range 4 east of Willamette Meridian, in King County State of Washington, the center line of said strip of right of way being more particularly described as follows to wit: Beginning at the point of intersection of the center line of definite location of the Seattle Tacoma Interurban Railway with the east line of the Northwest quarter (NW  $\frac{1}{4}$ ) of the Southwest quarter (SW  $\frac{1}{4}$ ) of Section 33, township 21, north, range 4 east W.M. south 0 deg. 24' west two hundred forty nine and five tenths (249.5) feet from the Northeast corner of the Northwest quarter (NW  $\frac{1}{4}$ ) of the Southwest quarter (SW  $\frac{1}{4}$ ) of said Section 33 thence curving to the left with a ten degree curve through fifty seven degrees and two minutes 57 deg. 02' of curvature a distance of five hundred seventy and three tenths (570.3) feet to a point which bears south 52 deg. 27' west five hundred forty seven and eight tenths (547.8) feet from the point of beginning; thence continuing curving to the left with a spiral of nine (9) chords each seventeen (17) feet long through 7 deg. 30' of curvature a distance of one hundred fifty three (153) feet to a point; thence south 16 deg. 26' west fifty five and seven tenths (55.7) feet to a point, thence curving to the right with a spiral having nine (9) chords of seventeen (17) feet each through seven degrees thirty minutes (7 deg. 30') of curvature a distance of one hundred fifty three (153) feet to a point thence continuing curving to the right with a 10 deg. curve through 10 deg. 34' of curvature a distance of one hundred five and seven tenths (105.7) feet to a point; thence continuing curving to the right with a spiral of nine (9) chords each seventeen (17) feet long through 7 deg 30' of curvature a

distance of one hundred fifty three (153) feet to a point thence south 42 deg. west two hundred fifty one and five tenths (251.5) feet to a point on the south line of the Northwest quarter {NW ¼} of the Southwest quarter (SW ¼) of Section 33, township 21 north, range 4 east, which bears south 89 deg. 51' east four hundred forty six and three tenths (446.3) feet from the southwest corner of the northwest quarter {NW ¼} of the Southwest quarter (SW ¼) of said section 33 said strip, piece or parcel of land containing three and thirty one one hundredths {3.31) acres of land in King County State of Washington.

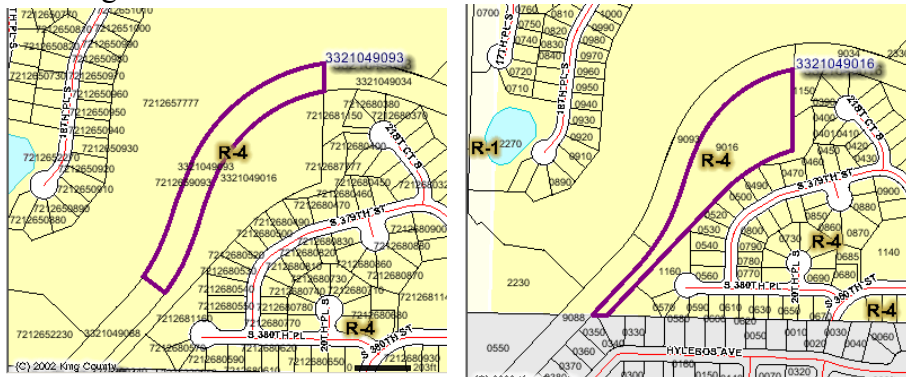

### **33-21-4 TL 34 Warranty Deed (Vol. 354. Pg. 6- AF # 257900)**

#### **George F. Stacy & George F. Stacy Trustee To Seattle Tacoma Interurban Railway**

A strip, piece or parcel of land one hundred (100) feet wide, being fifty (50) feet in width on each side of the center line of definite location of the Seattle- Tacoma Interurban Railway across the northwest quarter of the southeast quarter and the northeast quarter of the southwest quarter of Section thirty- three (33) Township twenty-one (21) North range four (4) east, Willamette Meridian, said center line being particularly described as follows: Beginning at a point on the south boundary line of the northwest quarter of the southeast quarter of section thirty-three (33) township twenty-one (21) north range four (4) east, Willamette Meridian, six hundred six (606) feet from the southeast corner of said north- west quarter of southeast quarter, which point is also located as follows: From a point on the east boundary line of the south west quarter of southeast quarter of said section thirty three (33) one hundred ninety and six tenths (190.6) feet from the north east corner of said southwest quarter of southeast quarter; thence north 77° 06' west three hundred twenty six and four tenths (326.4) feet to a point thence curving to the right with a spiral of nine (9) chords, each seventeen (17) feet long, through 7° 30' of curvature to a point; thence curving to the right with a ten degree curve through 14° 52' of curvature a distance of one hundred forty eight and six tenths (148.6) feet to said point of beginning; from said point of beginning continuing with said ten (10) degree curve to the right through 19° 22' of curvature a distance of one hundred ninety three and seven tenths (193.7) feet to a point; thence curving to the right with a spiral of nine (9) chords, each seventeen (17) feet long, through 7° 30' of curvature to a point; thence north 27° 52' west forty eight and three tenths (48.3) feet to a point thence curving to the left with a spiral of nine (9) chords each seventeen (17) feet long, through 7° 30' of curvature to a point thence curving to the left with a ten degree curve through 27° 22' of curvature a distance of two hundred and seventy three and seven tenths (273.7) feet to a point, thence curving to the left with a spiral of nine (9) chords, each seven- teen (17) feet long, through 7° 30' of curvature to a point; thence north 70° 14' west ten hundred forty eight and three tenths

(1048.3) feet to a point; thence curving to the left with a spiral of nine chords each seventeen (17) feet long through 7° 30' of curvature to a point; thence curving to the left with a ten (10) degree curve through 21° 18' of curvature a distance of two hundred eighteen (218) feet to a point on the west boundary line of the northeast quarter of southwest quarter of said section thirty-three (33) two hundred forty-nine and five tenths (249.5) feet from the northwest corner of said northeast quarter of southwest quarter; said strip piece or parcel of land containing five and fifty-one one hundredths (5.51) acres.

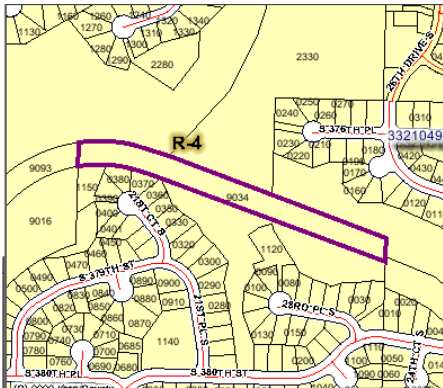

**33-21-4 TL 88 Warranty Deed (Vol. 308 Pg. 47- AF # 227479)**

**Carl G. M. Miller To Seattle Tacoma Interurban Railway**

A strip, piece or parcel of land one hundred (100) feet wide, namely fifty (50) feet in width on each side of the center line of definite location of the Seattle- Tacoma Interurban Railway across the south west quarter (SW ¼) of the south west quarter (SW ¼) of section thirty three (33), township twenty one (21) north, range four (4) east of the Willamette Meridian said center line being more fully described as follows: Beginning at a point on the north boundary line of the south west quarter (SW ¼) of the south west quarter (SW ¼) of section thirty three (33), township twenty one (21) north, range four (4) east of the Willamette Meridian four hundred and forty six (446) feet from the north west corner of said southwest quarter (SW ¼) of the south west quarter (SW ¼) thence south forty two (42) degrees no (00) minutes west six hundred seventy (670) feet to a point on the west boundary line of said south west quarter (SW ¼) of south west quarter (SW ¼) eight hundred fifteen and seven tenths (815.7) feet from the south west corner of said south west quarter (SW ¼) of south west quarter (SW ¼). Said strip, piece or parcel of land containing one and fifty three one hundredths (1.53) acres.

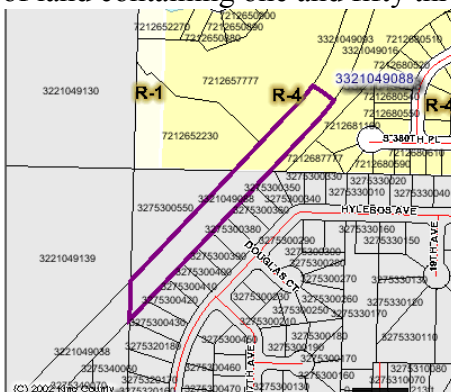

**34-21-4 TL 28 Warranty Deed (Vol. 345 Pg. 135 -AF # 250733)**

**Ole S. Ostrem & Mary Ostrem To Seattle- Tacoma Interurban Railway**

A strip, piece or parcel of land one hundred (100) feet wide, being fifty (50) feet in width on each side of the center line of definite location of the Seattle- Tacoma Interurban Railway across the south half of the southwest quarter of southwest quarter of section thirty-four (34) township twenty one (21) north range four (4) east, Willamette Meridian, said center line being particularly described as follows: Beginning at a point on the south boundary line of section thirty four (34) township twenty one (21) north range four (4) east, Willamette Meridian, three hundred eighteen (318) feet from the southwest corner of said section thirty four (34) thence north 43° 18' west four hundred fifty five and five tenths (455.5) feet to a point on the west boundary line and three hundred thirty seven (337) feet north from the southwest corner of said section thirty four said strip piece or parcel of land containing one and six one hundredths (1.06) acres.

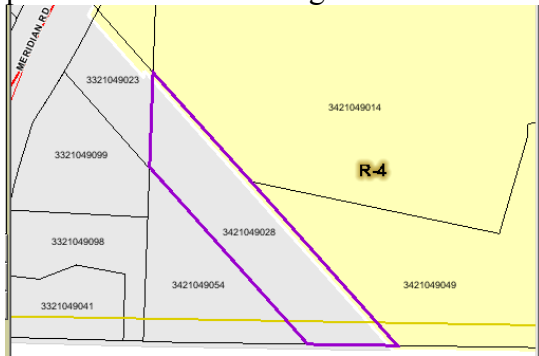

All situated in the County of King, State of Washington.

Section 2: The property described in Section 1 of this ordinance, and outlined above, shall become part of the City of Milton on the effective date of this ordinance.

Section 3: A certified copy of this ordinance shall be filed with the King County Council of King County, Washington, in which county said property is located.

Section 4 EFFECTIVE DATE: This Ordinance shall be in full force and effective five (5) days from and after its passage, approval, and publication as provided by law.

PASSED AND APPROVED by a vote of 7 for, 0 against, at a by the City Council of the City of Milton at a regularly scheduled meeting thereof this 7<sup>th</sup> day of June, 2004.

\_\_\_\_\_  
Katrina Asay, Mayor

Attested:

\_\_\_\_\_  
Maria Pierce, Finance Director/Clerk

Approved as to form:

---

Phil Olbrechts, City Attorney

Published 6-10-04

Effective Date 6-15-04